



DHN-LVWES05-G1

Rechargeable Lithium Iron Battery

The DHN-LVWES series product is a low-voltage energy storage battery designed to provide efficient and reliable energy storage solutions for households, businesses, and specific occasions. Adopting top tier brand lithium iron phosphate battery cells, with high safety, stability, energy density, and long cycle life. Built in efficient intelligent battery management system(BMS), comprehensively monitoring and controlling the battery energy storage system to ensure its safe, stable and high-performance operation.



Safe

- A-grade lithium iron phosphate battery with high safety performance.
- Intelligent BMS with multiple safety functions, making it safer to use.
- Fire Protection System: Optional Aerosol fire extinguisher.



Long Life-time

- Cycle life of over 6000 cycles (70% SOH).
- High parallel balancing current to ensure battery consistency.



Flexible

- Small size, high power density, Suitable for installation scenarios with limited space.
- Match with mainstream low-voltage energy storage inverters.



One-stop Service

- DAH Solar provide integrated system configuration services from PV to energy storage.

TECHNICAL PARAMETER

System Application

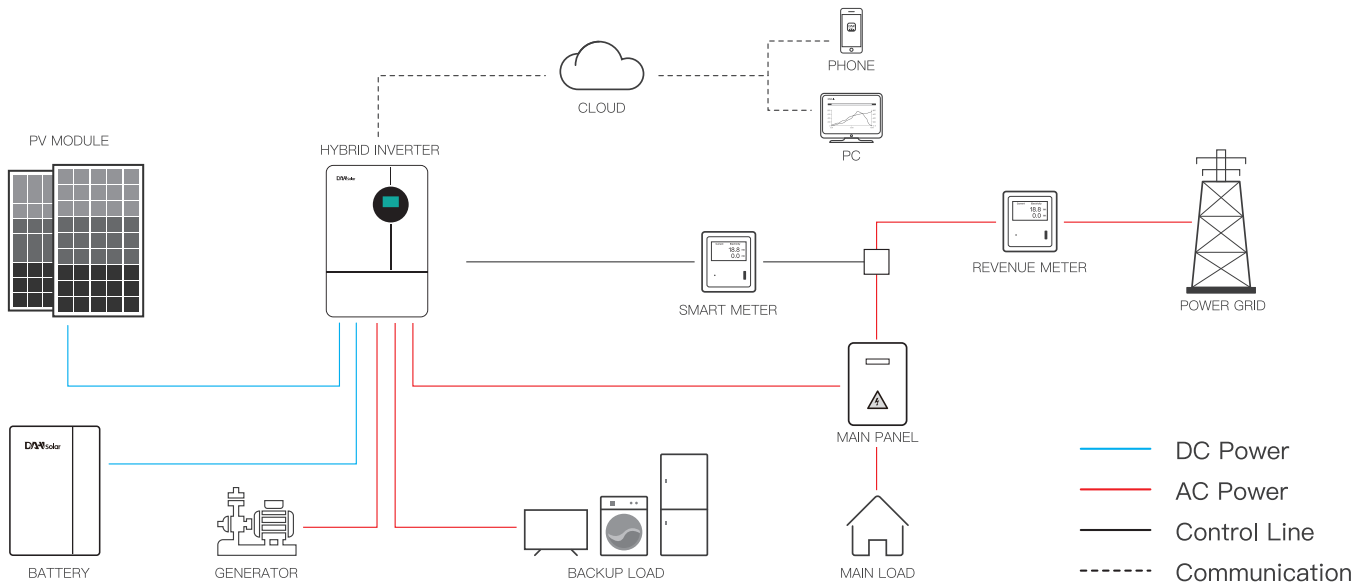

Technical Data

Model	DHN-LVWES05-G1
-------	----------------

Main Parameter

Battery Type	LiFePO4
Battery Rated Energy (kWh)	5.12
Battery Rated Capacity (Ah)	100
Scalability	Parallel connection of up to 16 units
Nominal Voltage (V)	51.2
Operating Voltage(V)	43.2~58.4
Charge/Discharge Current (A)-Recommend	50
Charge/Discharge Current (A)-Max.	100

Other Parameter

Recommend Depth of Discharge(%)	≤90
System Dimension (W/H/D, mm)	480x500x155
System Weight (kg)	47
Master LED Indicator	6LED (SOC:16.6%~100%), 3LED (ON/OFF,RUN,ALARM)
IP Rating of Enclosure	IP20
Operating Temperature(°C)	Charge:0~+60/Discharge:-20~+60
Storage Temperature(°C)	0~+35
Cycle Life (25±2°C,0.5C/0.5C,70%EOL)	≥6000
Installation	Wall-Mounted/Floor-Mounted
Fire Prevention System	Prefabricated whole fluorine ketone fire extinguishing device (optional)
Communication Methods	CAN2.0/RS485
Warranty Period (years)	5
Certification	IEC62619-CB,CE,UN38.3

Compatible Inverters SA/ICTRON/SE/DEYE/SOLIS/GOODWE/GROWATT/LUXPOWERTEK/SENERGY/SRD/SOLPLANET etc.